

QUEEN MARY 2®

GUIDE TO ACCOMMODATION & DECK PLANS

BRITANNIA ACCOMMODATION (DINING IN BRITANNIA RESTAURANT — DECKS 2 & 3)

Few ships offer such elegant, tastefully appointed standard staterooms as those in the Britannia accommodation on QUEEN MARY 2. These rooms range from gracious and affordable inside and oceanview staterooms to lovely premium balcony staterooms, each with a superb offering of amenities. Now, you can even stay connected at sea with new wireless connectivity in every stateroom and mobile phone service throughout most of the ship. When it comes time to dine, you'll enjoy the ambience of the spectacular two-storey Britannia Restaurant.

- Bon Voyage half bottle of sparkling wine upon embarkation
- 24-hour room service
- Satellite TV with multi-language film and music channels
- Direct-dial telephone, data port outlet and wi-fi access
- Refrigerator, digital locking safe, hair dryer
- Bathrobe & slippers
- Nightly turndown service with complimentary chocolate
- Daily shipboard newspaper
- 220V British 3-pin and 110V U.S. 2-pin sockets
- Fine soaps & shampoos



Standard Inside (D2) Approximately 157 square feet. King-size or twin-size beds, bathroom with shower.

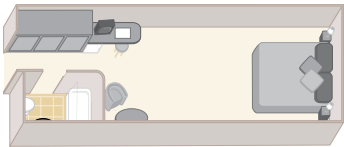

Standard Oceanview (C3) Approximately 194 square feet. King-size or twin-size beds, bathroom with shower.

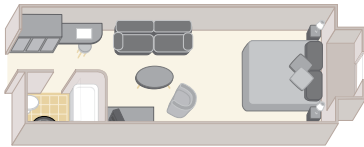

Premium Balcony (B3) Approximately 269 square feet. King-size or twin-size beds, sheltered balcony, bathroom with shower.

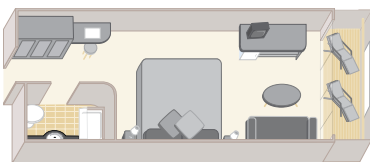

Deluxe Balcony (A1) Approximately 248 square feet. King-size or twin-size beds, bathroom with shower.

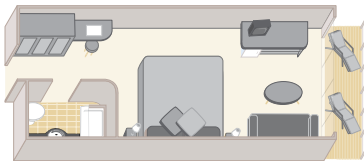

Note: Floor plans and stateroom diagrams represent typical arrangements. Certain staterooms may vary in size and configuration. Square footage varies based on stateroom category and deck location. Contact Cunard for more information.

BRITANNIA CLUB ACCOMMODATION (DINING IN BRITANNIA CLUB — DECK 2)

Those looking for a special experience can choose QUEEN MARY 2's Britannia Club accommodation. Here a select group of guests dine on delicious à la carte specialities in the intimate single-seating Britannia Club. A gracious balcony accommodation and additional amenities and details assure a blissful stay.



Britannia Club Balcony (AA) Approximately 248 square feet. King-size or twin-size beds, bathroom with shower.

ADDITIONAL BRITANNIA CLUB AMENITIES

- Bon Voyage bottle of sparkling wine & mineral water upon embarkation
- Soft terry bathrobes
- Fine linens
- Pillow Concierge Menu

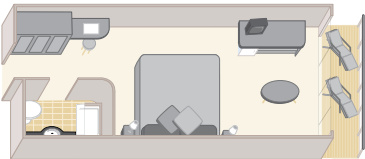

PRINCESS GRILL ACCOMMODATION (DINING IN PRINCESS GRILL — DECK 7)

Concierge services and a welcome bottle of sparkling wine are just a taste of the enhanced amenities in the lovely Princess Grill. Once you've settled into approximately 381 square feet of suite, you'll enjoy private venues like a lounge and single-seating dining in the enchanting Princess Grill restaurant.

- Single-seating dining in the Princess Grill, or en suite from the Princess Grill menu
- Access to private Concierge Lounge and Queens Grill Lounge
- Priority embarkation with separate Grill check-in
- Bon Voyage bottle of sparkling wine, mineral water & chocolate-covered strawberries upon embarkation
- Fruit basket & bud vase with orchid
- 24-hour room service
- Daily abridged newspaper
- Shoe shine service
- Fine linens & duvet, and Pillow Concierge Menu offering nine pillow options
- Terry cloth bathrobe & slippers
- Nightly turndown service with complimentary chocolate
- Fine soaps & shampoos



Princess Suite (P1) Approximately 381 square feet. Walk-in closet, balcony, full bathroom with tub and shower.

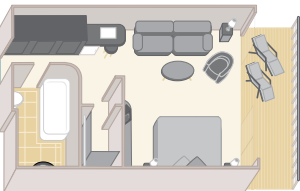

Note: Floor plans and stateroom diagrams represent typical arrangements. Certain staterooms may vary in size and configuration. Square footage varies based on stateroom category and deck location. Contact Cunard for more information.

QUEENS GRILL ACCOMMODATION (DINING IN QUEENS GRILL — DECK 7)

Treat yourself to truly the best suites at sea. QUEEN MARY 2's Queens Grill accommodation, where incredible amenities are paired with exclusive venues and services. Two Grand Duplexes (Q1) measure 2,249 square feet, whilst three Duplex Apartments (Q2) feature similar amenities. Queens Grill guests dine in the famous Queens Grill and enjoy use of their own Queens Grill Lounge and private sun terrace.

- Butler service (including packing/unpacking service)
- Single-seating Queens Grill dining or en suite from the Queens Grill menu
- Access to private Concierge Lounge, Queens Grill Lounge and private Grills Terrace Sun Deck
- Priority embarkation and luggage delivery with separate Grills check-in
- Bon Voyage bottle of Champagne, mineral water and chocolate-covered strawberries upon embarkation
- Fine linens & duvet, and Pillow Concierge Menu offering nine pillow options
- Flower arrangement, fruit basket & bottled water replenished daily
- Complimentary in-room bar & fully stocked refrigerator
- Personalised Cunard stationery & daily abridged newspaper
- In-room board games (chess/backgammon)
- 24-hour room service
- Shoe shine service
- Complimentary canapés
- Turndown service with "Sweet Dreams" surprise on formal nights
- Terry cloth bathrobe & slippers
- Extended line of fine soaps & shampoos; bath salts & manicure kit
- Umbrella and binoculars



Queen Suite (Q5) Approximately 506 square feet. Dressing room, bathroom with combination shower/whirlpool tub.



Royal Suite (Q3) Approximately 796 square feet. Master bathroom with shower, separate whirlpool tub.

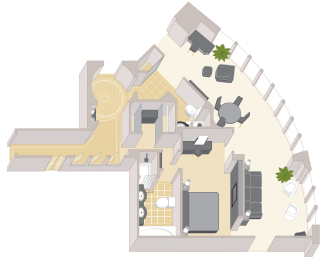

Duplex Apartments (Q2) Approximately 1,471 square feet. Upstairs bedroom, large balcony, 2 marble bathrooms, tubs and shower.

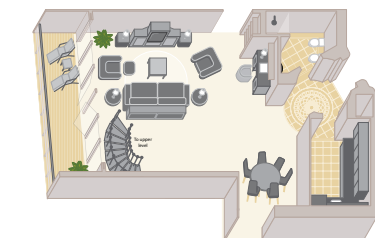

Downstairs



Grand Duplex (Q1) Approximately 2,249 square feet. Upstairs bedroom, large balcony, 2 marble bathrooms, tubs and shower.

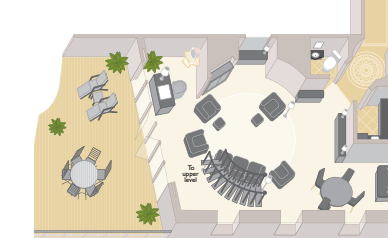
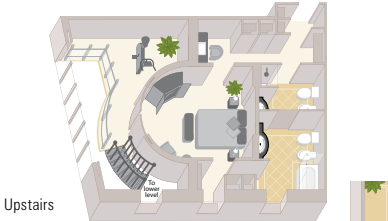

Downstairs

QUEENS GRILL

DECKS	CATEGORIES
9,10	Q1 Grand Duplex
9,10	Q2 Duplex Apartments Queen Mary & Queen Elizabeth Suites
10	Q3 Royal Suites
9,10	Q4 Penthouse
9,10,11	Q5 Queens Suites
9	Q6 Queens Suites
8,9	Q7 Queens Suites

PRINCESS GRILL

DECKS	CATEGORIES
10	P1 Princess Suites
10	P2 Princess Suites
10	P3 Princess Suites

BRITANNIA CLUB

DECKS	CATEGORIES
12	AA Britannia Club Balcony

BRITANNIA RESTAURANT

DECKS	CATEGORIES
11,12	A1 Deluxe Balcony
11	A2 Deluxe Balcony
8	A3 Deluxe Balcony
8	A4 Deluxe Balcony (Obstructed View)
6	B1 Premium Balcony (Sheltered)
5,6	B2 Premium Balcony (Sheltered)
4,5	B3 Premium Balcony (Sheltered)
4	B4 Premium Balcony (Sheltered)
4	B5 Premium Balcony (Sheltered)
5,6	C1 Standard Oceanview
4,5	C2 Standard Oceanview
6	C3 Standard Oceanview
5	C4 Standard Oceanview
5,6	D1 Atrium View
11,12	D2 Standard Inside
9,10	D3 Standard Inside
6	D4 Standard Inside
5,6	D5 Standard Inside
4,5	D6 Standard Inside
4	D7 Standard Inside
4	D8 Standard Inside

- L Lift
↔ Connecting staterooms
■ Wheelchair accessible (stateroom sizes vary)
+ Third berth is a single sofa bed
• Third and fourth berth is a double sofa bed
• Third and fourth berth are two upper beds
† A4, B5, B6 Staterooms have views partially obstructed by lifeboats
❖ Single-level Q2 Suite

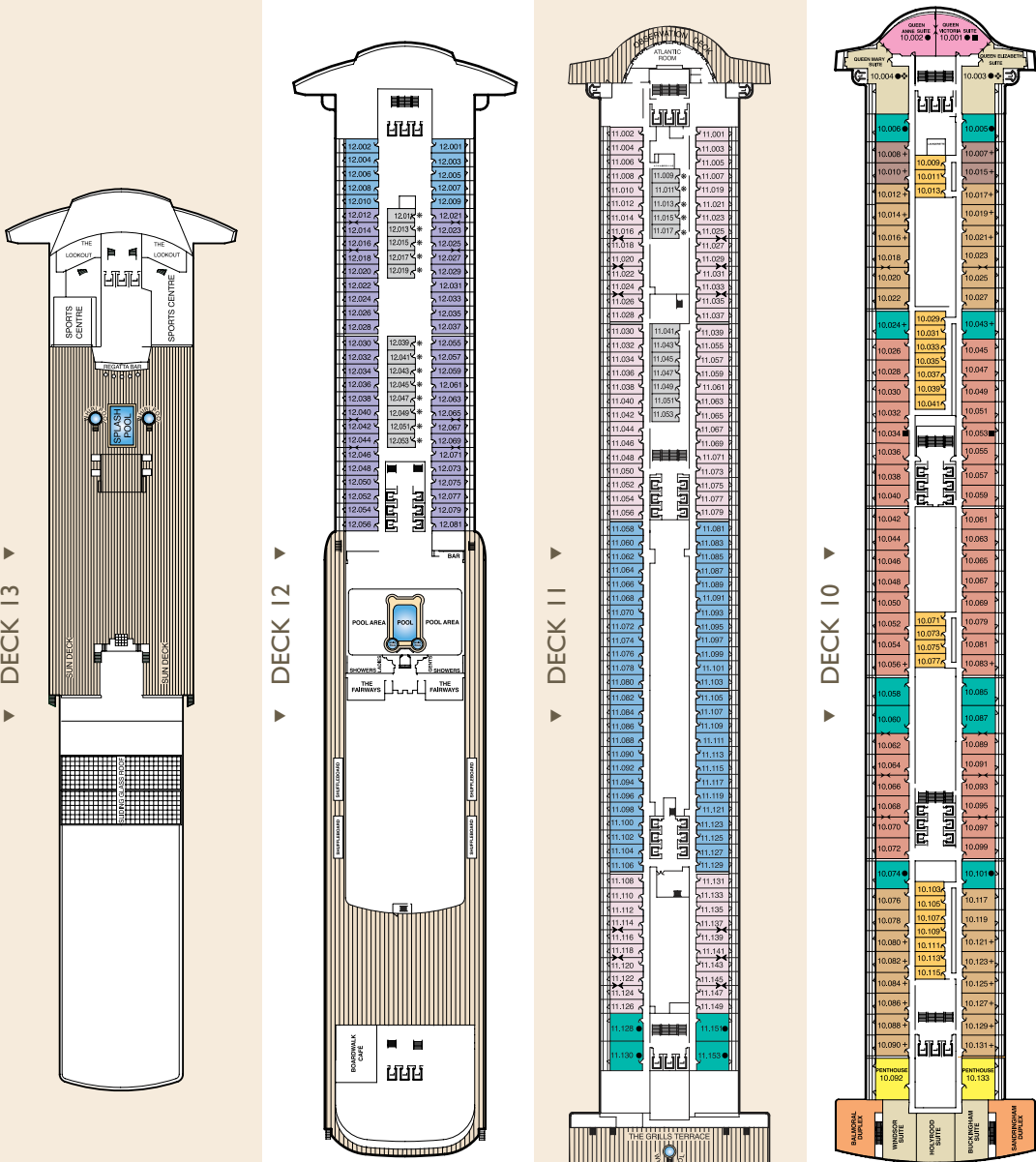

The following deck is not shown: Deck 1 includes Medical Centre and Tender Embarkation Lounges.
Ship deck plans and staterooms are for illustration purposes only. Actual staterooms may vary, decks are not to scale.

QUEEN MARY 2

Entered Service:	2004
Country of Registry:	Great Britain
Speed:	28 knots
Gross Tonnage:	151,400 tons
Guest Capacity:	2,604
Length:	1,132 feet
Width:	131 feet
Draft:	32 feet



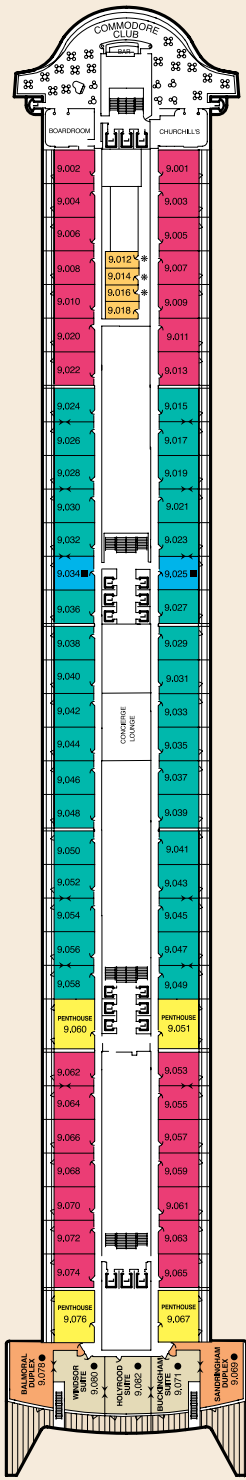

▼ DECK 9 ▼

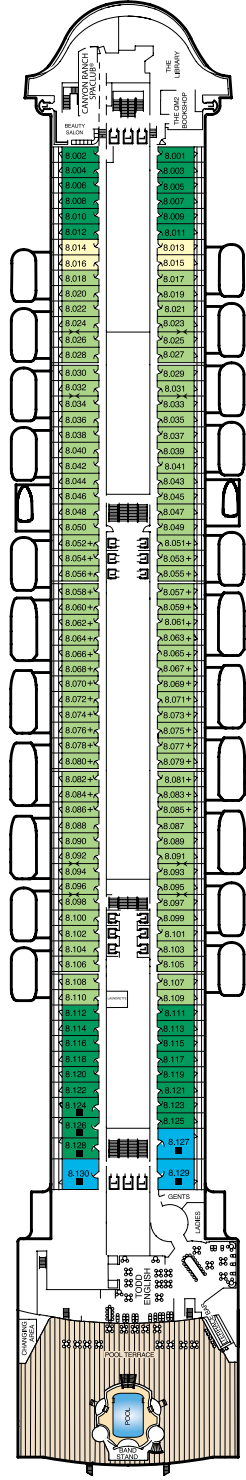

▼ DECK 8 ▼

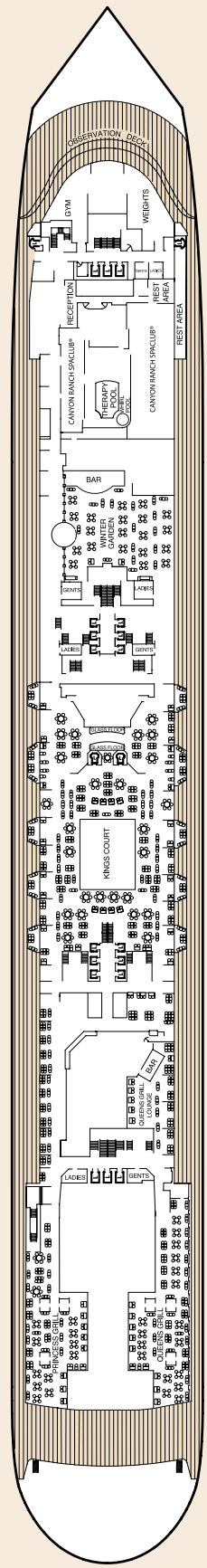

▼ DECK 7 ▼

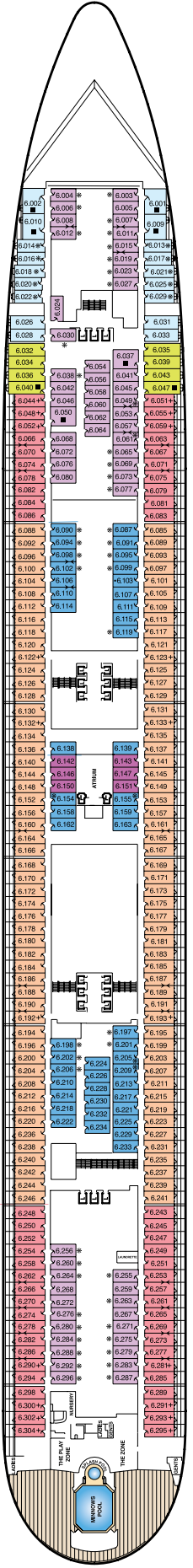

▼ DECK 6 ▼

▼ DECK 5 ▼

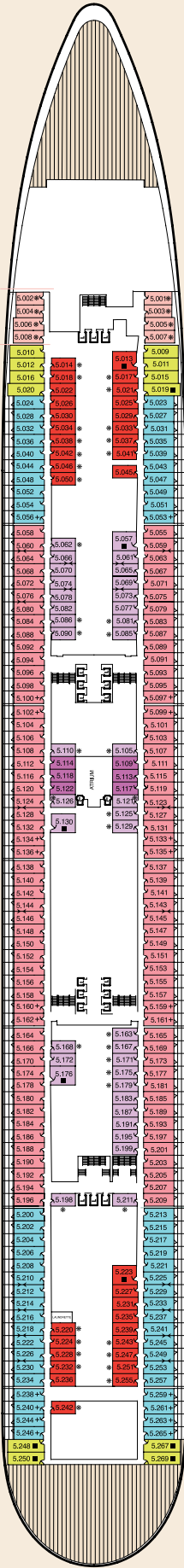

▼ DECK 4 ▼

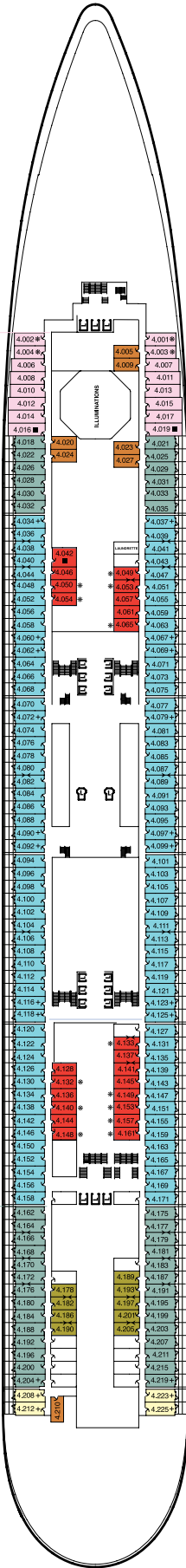

▼ DECK 3 & 3L ▼

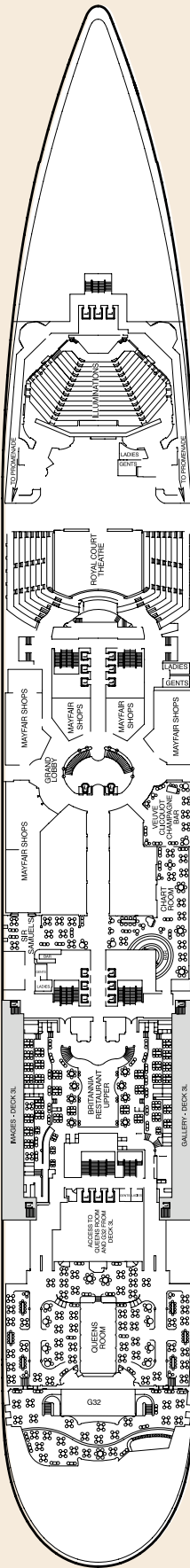

▼ DECK 2 & 3L ▼

